

F

E

D

C

B

A

1

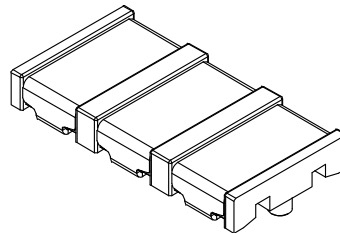
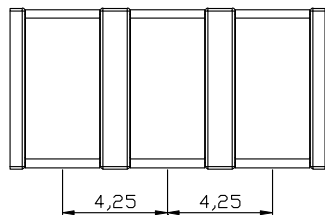

性能:

额定电流: 5.0A

额定电压: 30V

耐电压: 500V

接触电阻: 30mΩ max

绝缘电阻: 500MΩ

工作温度: -55℃~+125℃

使用寿命: 5000次以上

塑件(材质): PA9T黑色, 耐高温260℃

接触点(材质): 黄铜C2680, 触点镀金3U"

2

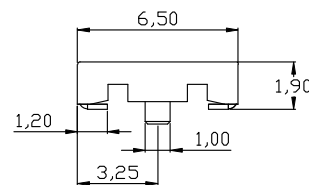
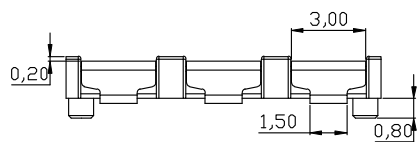

3

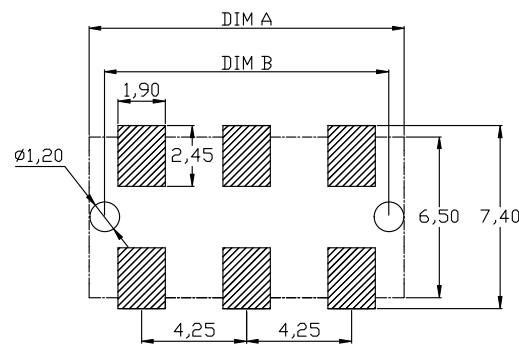
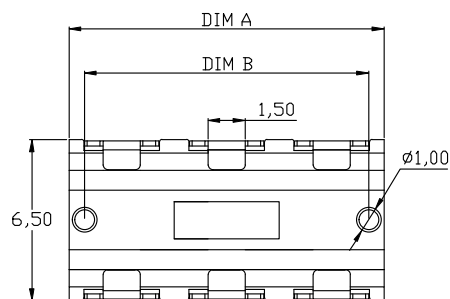

RECOMMENDED PCB LAYOUT  
TOP VIEW (.XX±0.05)

PART NO.	DIM A	DIM B
BC-0-206	8.50	7.25
BC-0-308	12.75	11.50
BC-0-408	17.00	15.75
BC-0-506	21.25	20.00
BC-0-606	25.50	24.25

4

NO.	PARTS	MATERIAL	QTY.	FINISHING
2	HOUSING	LCP	1	BLACK
1	CONTACT TERMINAL	PHOSPHORUS COPPER	3	Au PLATED

DISONG ELECTRONIC CO., LTD.

COPYRIGHT RESERVED, PLEASE DO NOT COPY.

PART NAME	CONNECTOR		DRAWING	G.B.Wu	DWG.No.	DS-BC-175
PART NO.	BC-0-206 308 408 506 606		CHECK	Q.L.Dai	REV.	A0
UNIT : mm	TOLERANCE	UP TO 5 ABOVE 5 30 ~ ABOVE 30 ANGLE	APPROVAL	SCALE	DATE	29-03-2022
	OTHERWISE	±0.2 ±0.3 ±0.5 ±3'	SCALE	2:1	PAGE	1 OF 1

F

E

D

C

B

A